

## Before Operating

Failure to follow warnings or instructions can cause serious injury or death.

The Operation and Maintenance Manual, Operator's Handbook, Safety Manual and machine signs (decals) provide proper operation and maintenance instructions.



The Service Schedule inside the tailgate provides service and maintenance instructions. Check fluid levels, lubricate and grease loader as required. Check for leaks, broken or damaged parts before operating.

**Never smoke when fueling!**



Know the location and function of all safety features and inter-locks, gauges and operating controls.

Activate the auxiliary hydraulics mode switch for hydraulic attachment operation.

 **Wear proper clothing and use personal protection equipment as required for the job.**

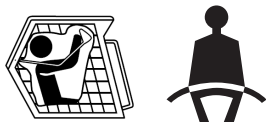

Always fasten the seat belt snugly and lower the seat bar for restraint.

## Servicing



Service and repair work should only be done by qualified service personnel.

If lift arms are raised for service, they must be secured by an approved lift arm support device.

## Transporting the Loader and Attachment



Always drive up the ramp with heavy end uphill. Engage parking brake.

Secure loader and attachments using tie-downs and chains. Use towing vehicle and trailer of adequate capacity.

## Options and Accessories

Additional machine options and accessories are available (i.e. single-point lifts, enclosures, back-up alarms, special application kits, etc.).

This brochure is also available in Spanish.

**Bobcat Company**

P.O. Box 6000 • West Fargo, ND 58078 • [www.bobcat.com](http://www.bobcat.com)

Printed in U.S.A.

B-1698 (11/08)

Kn-5M-1108-#15469-F



- **Safety rules for Bobcat skid-steer loaders.**
- **Know the equipment and the worksite before you operate.**
- **Remember: safe operation begins with the operator.**



**Bobcat**

*One Tough Animal*



**Bobcat**



# RENT IT SAFELY



## Know the Worksite

- Understand and comply with applicable laws and regulations.
- Call local utilities before you dig: 1-888-258-0808. Know the location of underground gas, water and electrical lines.
- Inspect work area for holes, drop-offs or unstable ground.
- Know the weight limitations of operating surfaces and clearances.



## Changing and Using Attachments

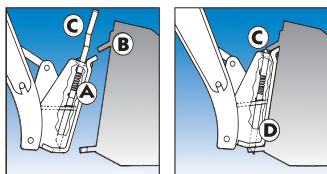

For fast, secure attachment change.  
**A** moves into attachment flange  
**B** handle **C** pushes down easily, pressing wedge **D** through frame and attachment hole for solid connection.

Make sure attachment is securely fastened to loader. Bob-Tach levers should be fully down and locked with wedges extended through attachment mounting holes. Use only approved attachments.



The attachment signs (decals) and Operator's Handbook provide operating and maintenance instructions. **Failure to follow warnings and instructions can cause serious injury or death.**



## Operator Training



The Bobcat Skid-Steer Loader Operator Training Course and a 10-minute safety video are available in English and Spanish. Check out the training resources link at [www.bobcat.com](http://www.bobcat.com).



## Getting On and Off Safely

Before leaving the operator's seat:

- 1 Lower lift arms and put attachment flat on the ground.
- 2 Stop the engine.
- 3 Engage the parking brake.
- 4 Raise seat bar and move controls until both lock.
- 5 Remove the key to prevent unauthorized starting.



Use the steps, grab-handles and skid-resistant surfaces when getting on or off the loader.

Do not jump off the loader.



## While Operating

- Start loader with steering levers and hydraulic controls in neutral. **Keep bystanders away.**



Move steering lever controls smoothly. Hydrostatic drive systems are responsive and loader will move immediately when controls are activated. Do not pull back suddenly on the steering lever controls to stop loader. Slow down when approaching the dump site.



Load, unload and turn on flat, level ground. Do not travel or turn with lift arms up.

**Carry the load low.**



**Keep bystanders away from loader and work area. Do not raise the lift arms and attachment over another worker.**



Never exceed loader's rated operating capacity (ROC).

Use the correct size bucket for the type and density of material being handled.



Always look in the direction of travel.

**Never carry riders or use loader as a manlift.**

Keep bystanders away from the work area.



On slopes, keep heavy end of loader uphill.

Travel directly up and down slopes, not across them.



**Keep hands and feet on controls or footrests. Never lean out the front of the cab with the engine running.**



Never operate loader's controls from the ground.

Always sit in the operator's seat when activating the controls.



Keep the bucket level when raising lift arms to prevent material from falling out of bucket.